

GRAND AVENUE

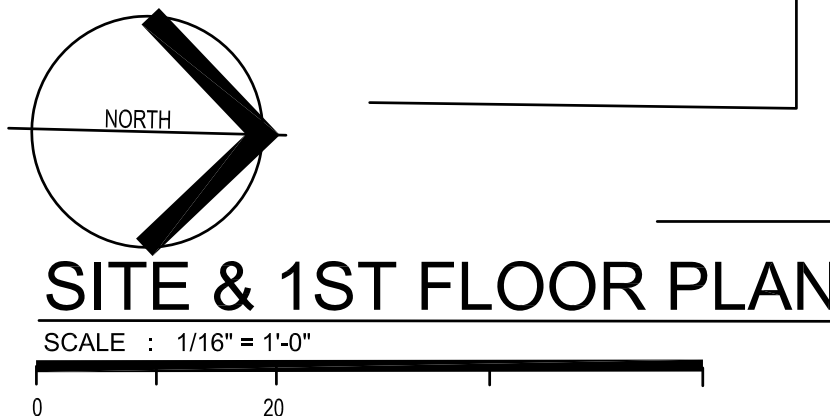
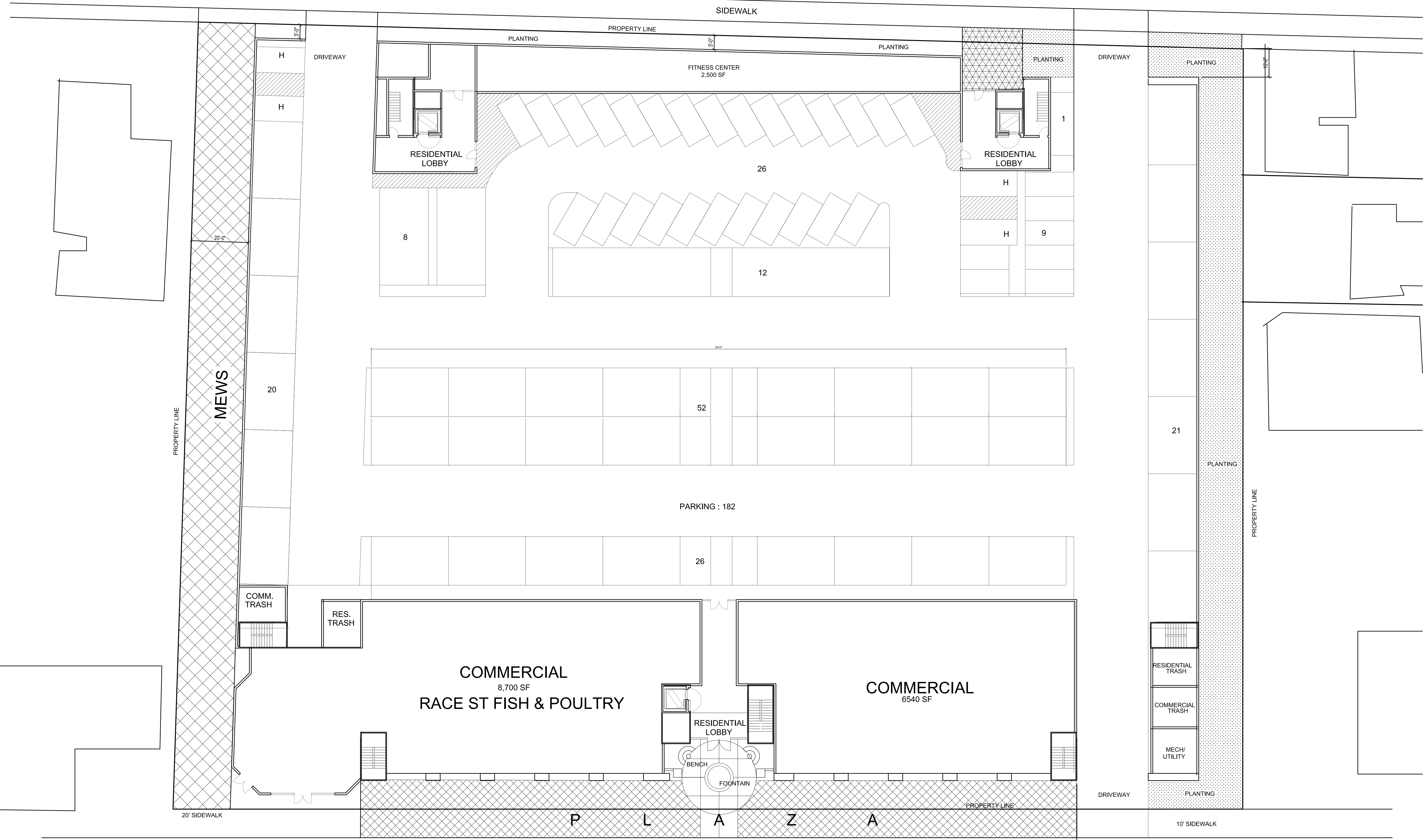

SITE & 1ST FLOOR PLAN

RACE STREET INVESTMENT LLC

1130 OLINDER COURT
SAN JOSE, CA 95122
Telephone : 408-294-6161
Fax : 408-294-2080

PD ZONING APPLICATION RACE STREET TERRACE

Race Street
SAN JOSE - CALIFORNIA

Date:	12-3-2010	Drawing Title:	FLOOR 1
Scale:	1/16" = 1'-0"	Sheet No.:	2
Revisions:		of	Sheets

LPMD
Architects
1288 Kifer Road, Unit 206
Sunnyvale, CA 94086
Telephone : 408-992-0280
Fax : 408-992-0281